

Truuli



Manor Road, Cheam, Sutton, Surrey, SM2

£425,000 Leasehold

- Two double bedrooms
- Traditional town house
- Garage
- Residential area
- Separate kitchen
- No onward chain

2, Lansdowne Road, Croydon, Surrey, CR9 2ER

Tel: 0330 043 0002

Email: save@truuli.co.uk Web: www.truuli.co.uk

Manor Road, Cheam, Sutton, Surrey, SM2

£425,000 Leasehold

A rare opportunity to acquire an exquisite two bedroom town house on Manor Road which is in walking distance of Cheam Rail Station.

Set at the start of Manor Road and part of Gainsborough Terrace this house has over 1000 square feet of living space. Upon entry on the ground floor there is a large hallway with built in storage and to the rear of the property there is a garage with a storage cupboard (which can be accessed with a vehicle off of Manor Road), a spacious utility room and a W.C. As you ascend to the first floor and keeping within traditional town house style you have a large lounge with balcony access and an abundance of light, a dining room and a separate kitchen. At the top of the property on the second floor there are two double bedrooms, both with built in wardrobes and a three piece shower suite.

Manor Road is located two roads away from Cheam Railway Station offering regular Southern Railway Services to Epsom, London Bridge (via Sutton), Dorking, Clapham Junction & London Victoria. Manor Road is also just off of the A217. The property is also offered to the market with no onward chain so you could be in your new home within weeks.

Gainsborough Terrace

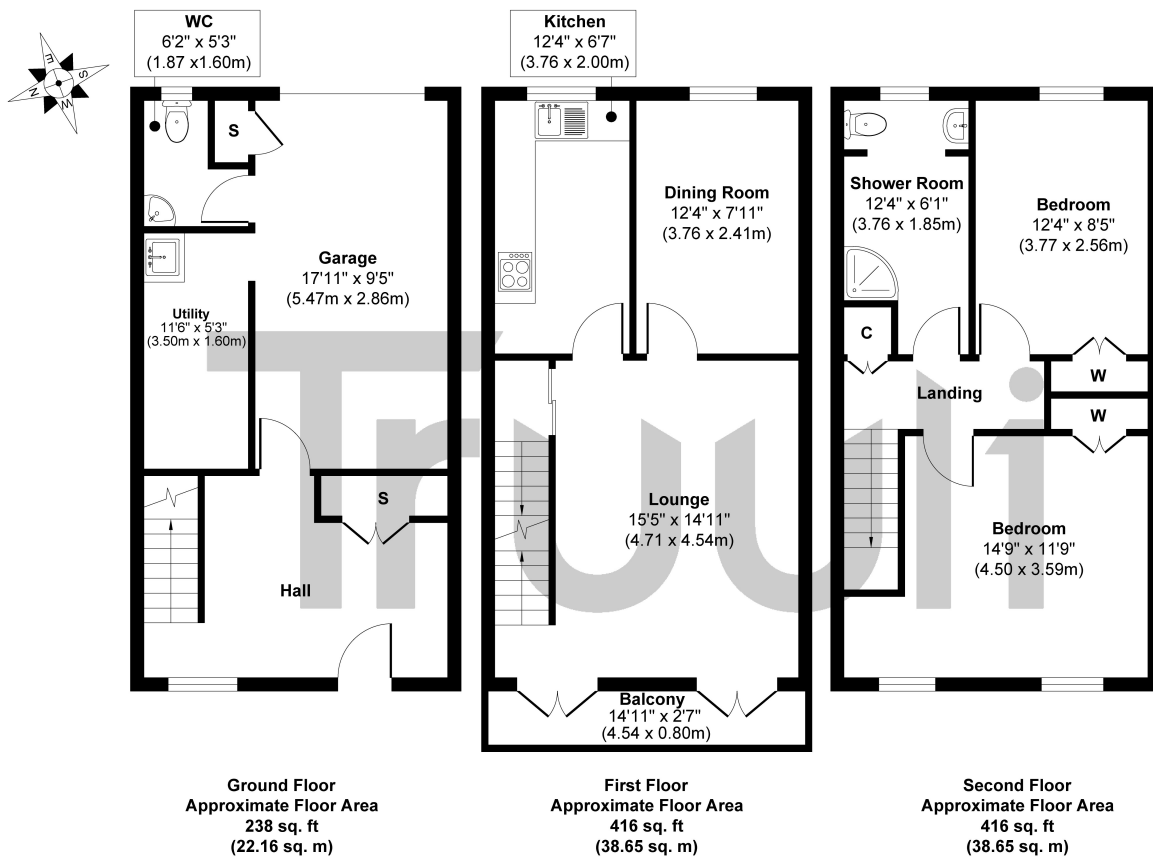

Approx. Gross Internal Floor Area 1070 sq. ft / 99.46 sq. m

Produced by Elements Property

