

Truuli



Sanctuary, Lower Addiscombe Road, Croydon, Surrey, CR0

£350,000 Leasehold

- Private courtyard
- Gated development
- Close to Addiscombe High Street
- London Help To Buy
- Large double bedroom
- Sublime finish throughout
- Brand new apartment

2, Lansdowne Road, Croydon, Surrey, CR9 2ER

Tel: 0330 043 0002

Email: save@truuli.co.uk Web: www.truuli.co.uk

Sanctuary, Lower Addiscombe Road, Croydon, Surrey, CR0

£350,000 Leasehold

HELP TO BUY Truuli New Homes are delighted to present to you, The Sanctuary. This is an exciting opportunity to purchase a delightful lower ground floor apartment on Lower Addiscombe Road, oozing with period features and finished to a sublime standard throughout. For first time buyers this property is available on the London Help To Buy Mortgage scheme (please enquire for further information and clarification).

Acquiring approximately 565 square feet this lower ground floor apartment comprises of; a large double bedroom with built in storage, a delightful three piece bathroom suite and an open plan kitchen and reception room. This apartment also has a private courtyard the full width of the apartment and there are a limited number of parking spaces available to purchase in addition to the apartment. Homeowners will also be entitled to access the communal gardens situated behind the building

The Sanctuary is a secure, gated development on Lower Addiscombe Road, allowing you to be moments away from Addiscombe High Street and within walking distance of East Croydon Rail Station. Addiscombe Tram Stop is approximately 0.2 miles away.

Flat 1, The Sanctuary

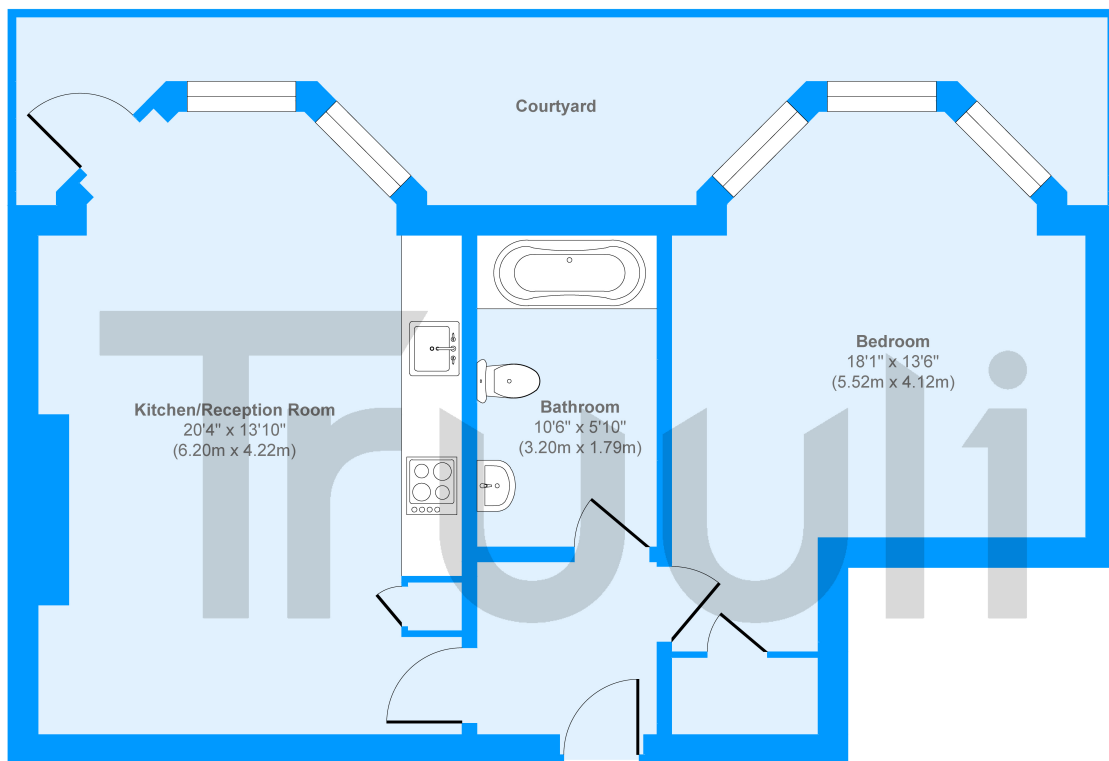

Lower Ground Floor
Approximate Floor Area
565 sq. ft
(52.50 sq. m)

Approx. Gross Internal Floor Area 565 sq. ft / 52.50 sq. m

Produced by Elements Property

