

Truuli



Radnor House, London Road, London, SW16

One Thousand Four Hundred £1,450 pcm Not Applicable

- Ample storage space
- Allocated parking space
- Double glazed
- Close proximity to all local transport and amenities
- Spacious accommodation throughout
- Large open plan kitchen and living room
- Part Furnished
- Available end July 2022

2, Lansdowne Road, Croydon, London, CR9 2ER

Tel: 0330 043 0002

Email: save@truuli.co.uk Web: www.truuli.co.uk

Radnor House, London Road, London, SW16

One Thousand Four Hundred £1,450 pcm Not Applicable

Presenting this chic and spacious two-bedroom, two-bathroom apartment on the third floor, situated within a modern development in Norbury.

The property briefly comprises; a large reception room with a dining area and a stylish semi-open planned kitchen with integrated appliances. Master bedroom with en-suite shower room and fitted wardrobes, a further large double bedroom and a three-piece family bathroom. Furnished to a high standard, the property has wooden flooring throughout, ample storage space and also provides allocated parking.

Radnor House is in the centre of Norbury; close to bars, restaurants, shops, cafes and Nuffield Health Club. Local parks including Norbury Hall Park are within a short walk and access to both London Bridge and Victoria is roughly 30mins, provided via Norbury Station which is within close proximity.

Viewing comes highly recommended.

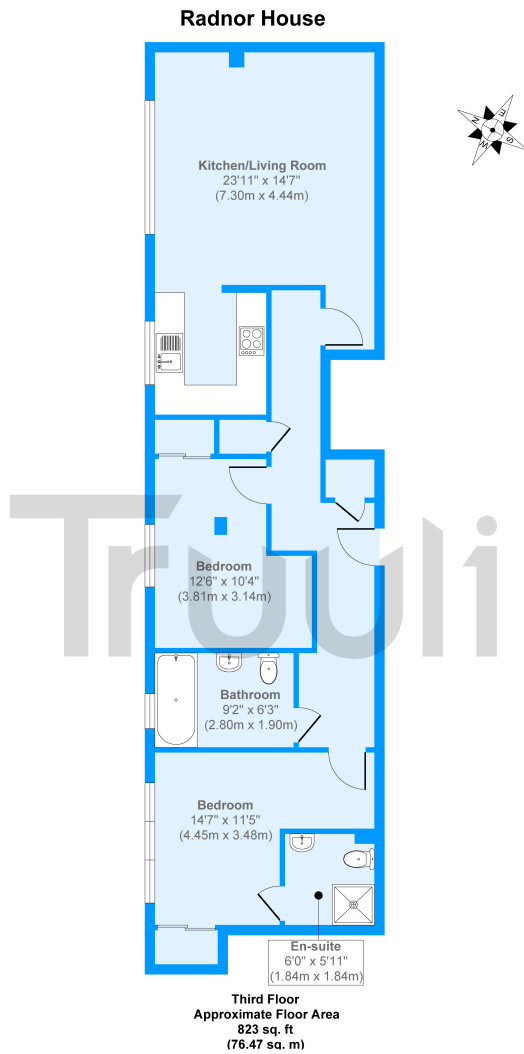

Approx. Gross Internal Floor Area 823 sq. ft / 76.47 sq. m
Produced by Elements Property

Energy Efficiency Rating		Environmental Impact (CO ₂) Rating																													
Current	Potential	Current	Potential																												
Very energy efficient - lower running costs																															
Very environmentally friendly - lower CO ₂ emissions																															
<table border="1"> <tr><td>(92 to 100) A</td><td></td></tr> <tr><td>(81 to 91) B</td><td></td></tr> <tr><td>(69 to 80) C</td><td></td></tr> <tr><td>(55 to 68) D</td><td></td></tr> <tr><td>(39 to 54) E</td><td></td></tr> <tr><td>(21 to 38) F</td><td></td></tr> <tr><td>(1 to 20) G</td><td></td></tr> </table>		(92 to 100) A		(81 to 91) B		(69 to 80) C		(55 to 68) D		(39 to 54) E		(21 to 38) F		(1 to 20) G		<table border="1"> <tr><td>(92 to 100) A</td><td></td></tr> <tr><td>(81 to 91) B</td><td></td></tr> <tr><td>(69 to 80) C</td><td></td></tr> <tr><td>(55 to 68) D</td><td></td></tr> <tr><td>(39 to 54) E</td><td></td></tr> <tr><td>(21 to 38) F</td><td></td></tr> <tr><td>(1 to 20) G</td><td></td></tr> </table>		(92 to 100) A		(81 to 91) B		(69 to 80) C		(55 to 68) D		(39 to 54) E		(21 to 38) F		(1 to 20) G	
(92 to 100) A																															
(81 to 91) B																															
(69 to 80) C																															
(55 to 68) D																															
(39 to 54) E																															
(21 to 38) F																															
(1 to 20) G																															
(92 to 100) A																															
(81 to 91) B																															
(69 to 80) C																															
(55 to 68) D																															
(39 to 54) E																															
(21 to 38) F																															
(1 to 20) G																															
<table border="1"> <tr><td>82</td><td>83</td></tr> </table>		82	83	<table border="1"> <tr><td>72</td><td>74</td></tr> </table>		72	74																								
82	83																														
72	74																														
Not energy efficient - higher running costs																															
Not environmentally friendly - higher CO ₂ emissions																															
EU Directive 2002/91/EC		EU Directive 2002/91/EC																													
England, Wales & N.Ireland		England, Wales & N.Ireland																													

