

Truuli



Vita Apartments, Caithness Walk, Croydon, Surrey, CR0

£420,000 Leasehold

- Moments away from East Croydon Railway Station
- Beautiful communal gardens
- Modern building
- Two double bedrooms
- Views from each room
- Private balcony
- Built in storage

2, Lansdowne Road, Croydon, Surrey, CR9 2ER

Tel: 0330 043 0002

Email: save@truuli.co.uk Web: www.truuli.co.uk

Vita Apartments, Caithness Walk, Croydon, Surrey, CR0

£420,000 Leasehold

Please click here to see vendor comments about their home.

Vita Apartments

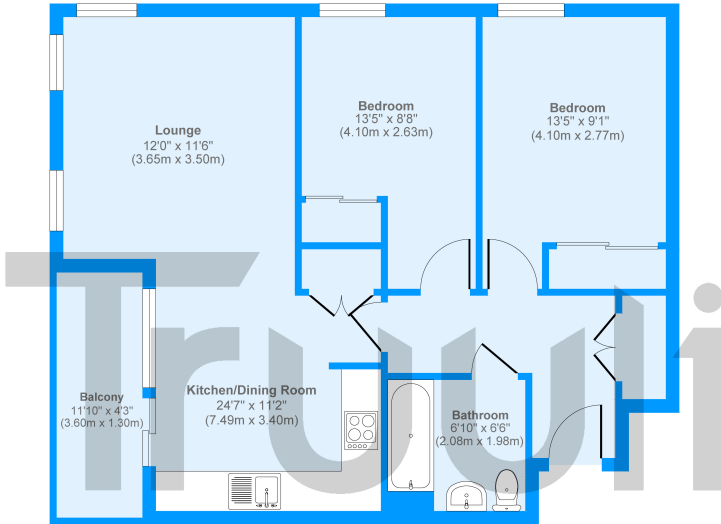

Twelfth Floor Flat
Approximate Floor Area
646 sq. ft
(60.10 sq. m)

Approx. Gross Internal Floor Area 646 sq. ft / 60.10 sq. m
Produced by Elements Property

Energy Efficiency Rating		Environmental Impact (CO ₂) Rating	
Current	Potential	Current	Potential
<p>Very energy efficient - lower running costs</p> <p>(92 to 100) A</p> <p>(81 to 91) B</p> <p>(69 to 80) C</p> <p>(55 to 68) D</p> <p>(39 to 54) E</p> <p>(21 to 38) F</p> <p>(1 to 20) G</p> <p>Not energy efficient - higher running costs</p>		<p>Very environmentally friendly - lower CO₂ emissions</p> <p>(92 to 100) A</p> <p>(81 to 91) B</p> <p>(69 to 80) C</p> <p>(55 to 68) D</p> <p>(39 to 54) E</p> <p>(21 to 38) F</p> <p>(1 to 20) G</p> <p>Not environmentally friendly - higher CO₂ emissions</p>	
	82	87	87
<p>EU Directive 2002/91/EC</p> <p>England, Wales & N.Ireland</p>		<p>EU Directive 2002/91/EC</p> <p>England, Wales & N.Ireland</p>	

