

Truuli



Selhurst New Road, London, SE25

£550,000 Freehold

- Side access to property and garden
- Set up for entertaining
- Redecorated throughout
- Brand new boiler with Hive heating system
- Garden ideal for BBQs and hosting
- Potential to extend the rear
- Four piece bathroom suite
- Master bedroom on top floor with en suite

2, Lansdowne Road, Croydon, Surrey, CR9 2ER

Tel: 0330 043 0002

Email: save@truuli.co.uk Web: www.truuli.co.uk

Selhurst New Road, London, SE25

£550,000 Freehold

Vendor comments: "When looking for our home we wanted more space but didn't want to compromise on transport links. We fell in love with Selhurst as it gave us space and the garden we wanted, yet so close to Selhurst station (4min), Northwood Junction (15min) and East Croydon (20min) which made accessing the west or east of London quick. At the time, I was working in Canary Wharf and it was a nice change to get a seat on the Overground rather than be crammed on a tube.

We were looking for a home which was set up for entertaining and also offering the potential to extend. We started our transformation; redecorating thorough out and creating an open living space which is perfect for relaxing and having friends over. Also, we transformed the bathroom and I will miss our lovely titles. We installed a brand new Worcester boiler with Hive heating system. We have found the garden to be a perfect size; it is big enough to have summer BBQs as well as sunbathe and the mowing does not take up too much time either. The side access has been perfect for bikes, garden toys and the shed plus outdoor storage provides plenty of space.

Locally we have a Co-operative convenience store no further than 100m from the house and a large Sainsbury's a 5min drive away.

Sadly, a new job means relocation, so sadly we are moving on. We will be handing over our gorgeous home for you to enjoy and shall miss it dearly!"

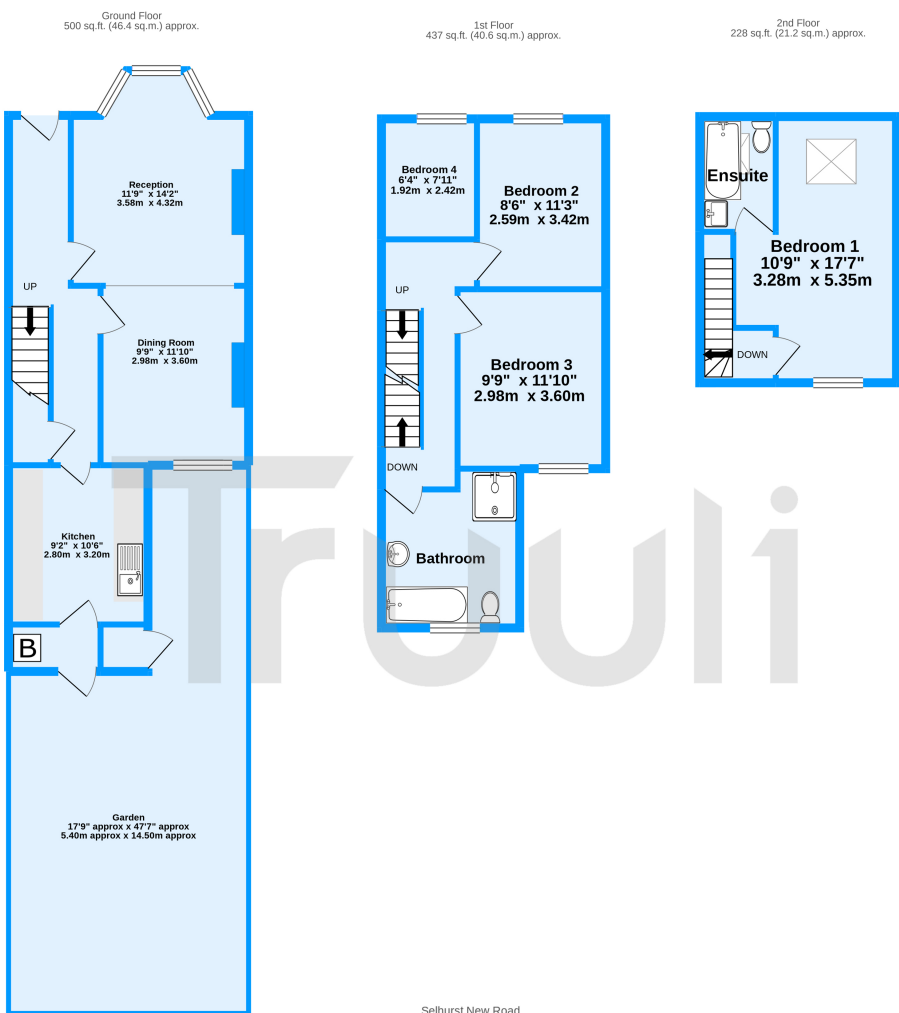

Selhurst New Road
TOTAL FLOOR AREA : 1164 sq.ft. (108.2 sq.m.) approx.
Whilst every attempt has been made to ensure the accuracy of the floorplan contained here, measurements of doors, windows, rooms and any other items are approximate and no responsibility is taken for any error, omission or mis-statement. This plan is for illustrative purposes only and should be used as such by any prospective purchaser. The services, systems and appliances shown have not been tested and no guarantee as to their operability or efficiency can be given.
Made with Metropix ©2020

