

Truuli



Camden Hill Road, London, SE19

£415,000 Leasehold

- Victorian conversion
- Share of freehold
- Recently refurbished
- Modern fitted kitchen with integrated appliances
- Subway tiled wet room
- Neutral decor
- Bay fronted master bedroom
- Private rear garden
- Walking distance from transport links
- Potential to extend (STPP)

2, Lansdowne Road, Croydon, London, CR9 2ER

Tel: 0330 043 0002

Email: save@truuli.co.uk Web: www.truuli.co.uk

Camden Hill Road, London, SE19

£415,000 Leasehold

Please click to read "vendor comments" and arrange a viewing for this stunning one bedroom Victorian conversion.

Camden Hill Road, SE19

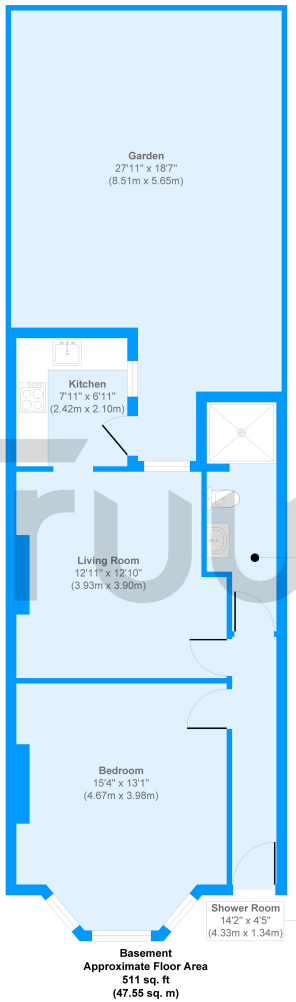

Approx. Gross Internal Floor Area 511 sq. ft / 47.55 sq. m
Produced by Elements Property

Energy Efficiency Rating		Environmental Impact (CO ₂) Rating	
Current	Potential	Predicted	
<p>Very energy efficient - lower running costs</p> <p>(92 to 100) A</p> <p>(81 to 91) B</p> <p>(69 to 80) C</p> <p>(55 to 68) D</p> <p>(39 to 54) E</p> <p>(21 to 38) F</p> <p>(1 to 20) G</p> <p>Not energy efficient - higher running costs</p>		<p>Very environmentally friendly - lower CO₂ emissions</p> <p>(92 to 100) A</p> <p>(81 to 91) B</p> <p>(69 to 80) C</p> <p>(55 to 68) D</p> <p>(39 to 54) E</p> <p>(21 to 38) F</p> <p>(1 to 20) G</p> <p>Not environmentally friendly - higher CO₂ emissions</p>	
64	74		0
<p>EU Directive 2002/91/EC</p> <p>England, Wales & N.Ireland</p>		<p>EU Directive 2002/91/EC</p> <p>England, Wales & N.Ireland</p>	

