



## Green Lane, London, SW16

£725,000 Freehold

- Well maintained family home
- Off street for multiple cars
- Natural four bedroom family home
- Useable loft room accessed via ladder
- Situated close to Norbury Park BMX Track and Boxing club
- Close to "Good" rated ofsted primary schools

# Green Lane, London, SW16

£725,000 Freehold

\*\*\* Guide price £725,000 - £750,000 \*\*\* A very spacious four bedroom semi-detached family home located on the ever-popular Green Lane in Norbury. This property will suit a large family or growing family.

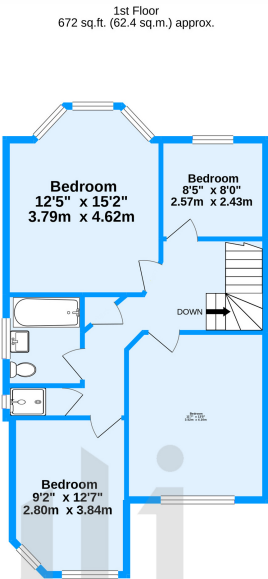
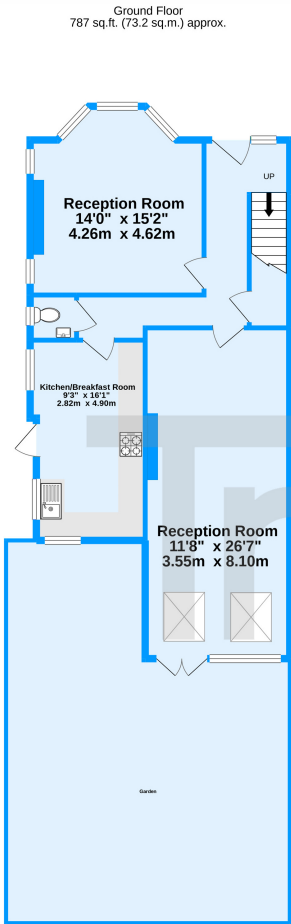

TOTAL FLOOR AREA : 1459 sq.ft. (135.6 sq.m.) approx.  
Whilst every attempt has been made to ensure the accuracy of the floorplan contained here, measurements of doors, windows, rooms and any other items are approximate and no responsibility is taken for any error, omission or mis-statement. This plan is for illustrative purposes only and should be used as such by any prospective purchaser. The services, systems and appliances shown have not been tested and no guarantee as to their operability or efficiency can be given.  
Made with Metropix ©2021

Energy Efficiency Rating			Environmental Impact (CO <sub>2</sub> ) Rating	
	Current	Potential		Predicted
Very energy efficient - lower running costs			Very environmentally friendly - lower CO <sub>2</sub> emissions	
(92 to 100) <b>A</b>			(92 to 100) <b>A</b>	
(81 to 91) <b>B</b>		83	(81 to 91) <b>B</b>	
(69 to 80) <b>C</b>	69		(69 to 80) <b>C</b>	
(55 to 68) <b>D</b>			(55 to 68) <b>D</b>	
(39 to 54) <b>E</b>			(39 to 54) <b>E</b>	
(21 to 38) <b>F</b>			(21 to 38) <b>F</b>	
(1 to 20) <b>G</b>			(1 to 20) <b>G</b>	0
Not energy efficient - higher running costs			Not environmentally friendly - higher CO <sub>2</sub> emissions	
England, Wales & N.Ireland	EU Directive 2002/91/EC		England, Wales & N.Ireland	EU Directive 2002/91/EC

