

# Truuli



## Windermere Road, London, SW16

£525,000 Freehold

- Off street parking
- Room to extend subject to planning consents
- Excellent transport connections
- Well maintained family home
- Additional ground floor shower room
- Good order throughout
- Guide price £525,000 - £550,000

2, Lansdowne Road, Croydon, Surrey, CR9 2ER

Tel: 0330 043 0002

Email: [save@truuli.co.uk](mailto:save@truuli.co.uk) Web: [www.truuli.co.uk](http://www.truuli.co.uk)

# Windermere Road, London, SW16

£525,000 Freehold

\*\*\* Guide price £525,000 - £550,000 \*\*\* A lovely well-maintained family home situated on Windermere Road, Streatham. The location is enviable for all local transport and amenities that the area has to offer.

Ground Floor  
500 sq.ft. (46.5 sq.m.) approx.

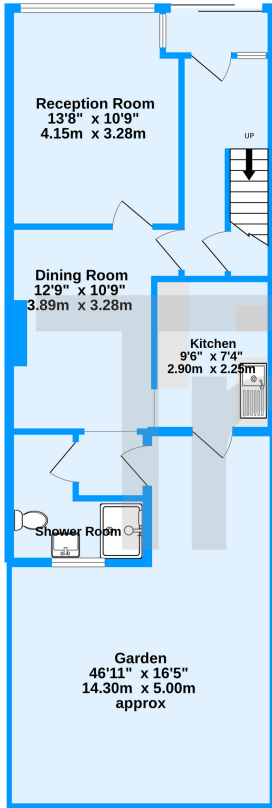

1st Floor  
414 sq.ft. (38.5 sq.m.) approx.

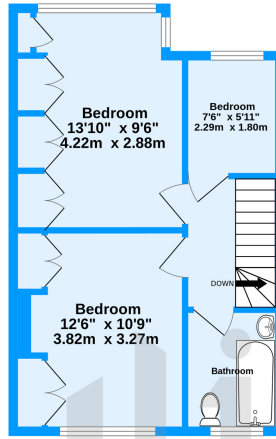

Windermere Road, Streatham Vale, SW16

TOTAL FLOOR AREA : 915 sq.ft. (85.0 sq.m.) approx.

Whilst every attempt has been made to ensure the accuracy of the floorplan contained here, measurements of doors, windows, rooms and any other items are approximate and no responsibility is taken for any error, omission or mis-statement. This plan is for illustrative purposes only and should be used as such by any prospective purchaser. The services, systems and appliances shown have not been tested and no guarantee as to their operability or efficiency can be given.  
Made with Metropix ©2022

