

Truuli



Rigby Close, Croydon, Surrey, CR0

£300,000 Leasehold

- First floor flat
- Access to communal gardens
- In between Town Centre and Purley Retail Park
- Well maintained and presented throughout
- Cul-de-sac location
- Well-equipped fitted kitchen
- Double glazing & central heating
- Own locked storage cupboard
- Three double bedrooms
- Three piece bathroom suite

2, Lansdowne Road, Croydon, Surrey, CR9 2ER

Tel: 0330 043 0002

Email: save@truuli.co.uk Web: www.truuli.co.uk

Rigby Close, Croydon, Surrey, CR0

£300,000 Leasehold

A well-presented first-floor purpose-built flat with access to lawned communal gardens in Rigby Close, set within a short walk of Wandle Park tramlink and Croydon town centre.

First Floor
690 sq.ft. (64.1 sq.m.) approx.

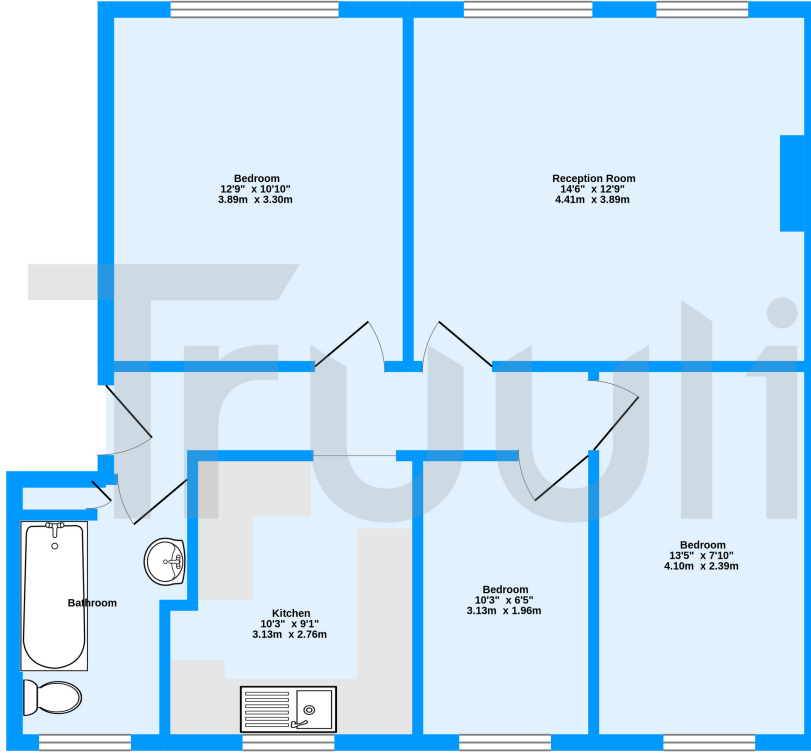

Rigby Close, Croydon, CR0
TOTAL FLOOR AREA: 690 sq.ft. (64.1 sq.m.) approx.
Measurements are approximate. Not to scale. Illustrative purposes only
Made with Metropix ©2022

Energy Efficiency Rating		Current	Potential
Very energy efficient - lower running costs			
(92-100)	A		
(81-91)	B		
(69-80)	C	73	79
(55-68)	D		
(39-54)	E		
(21-38)	F		
(1-20)	G		
Not energy efficient - higher running costs			
England, Scotland & Wales		EU Directive 2002/91/EC	

