

# Truuli



## Burlington Road, Thornton Heath, Surrey, CR7

£525,000 Freehold

- Three double bedroom family home
- Downstairs WC and utility room
- Well maintained and presented throughout
- Easy commutable access to Crystal Palace
- Retained period features
- Main bathroom and en-suite

2, Lansdowne Road, Croydon, Surrey, CR9 2ER

Tel: 0330 043 0002

Email: [save@truuli.co.uk](mailto:save@truuli.co.uk) Web: [www.truuli.co.uk](http://www.truuli.co.uk)

# Burlington Road, Thornton Heath, Surrey, CR7

£525,000 Freehold

A lovely Victorian family home with three double bedrooms, two bathrooms and three toilets located on Burlington Road, Thornton Heath.

The property is within an easily commutable distance to Crystal Palace and the ever-popular Triangle with its independent boutiques and cafes.

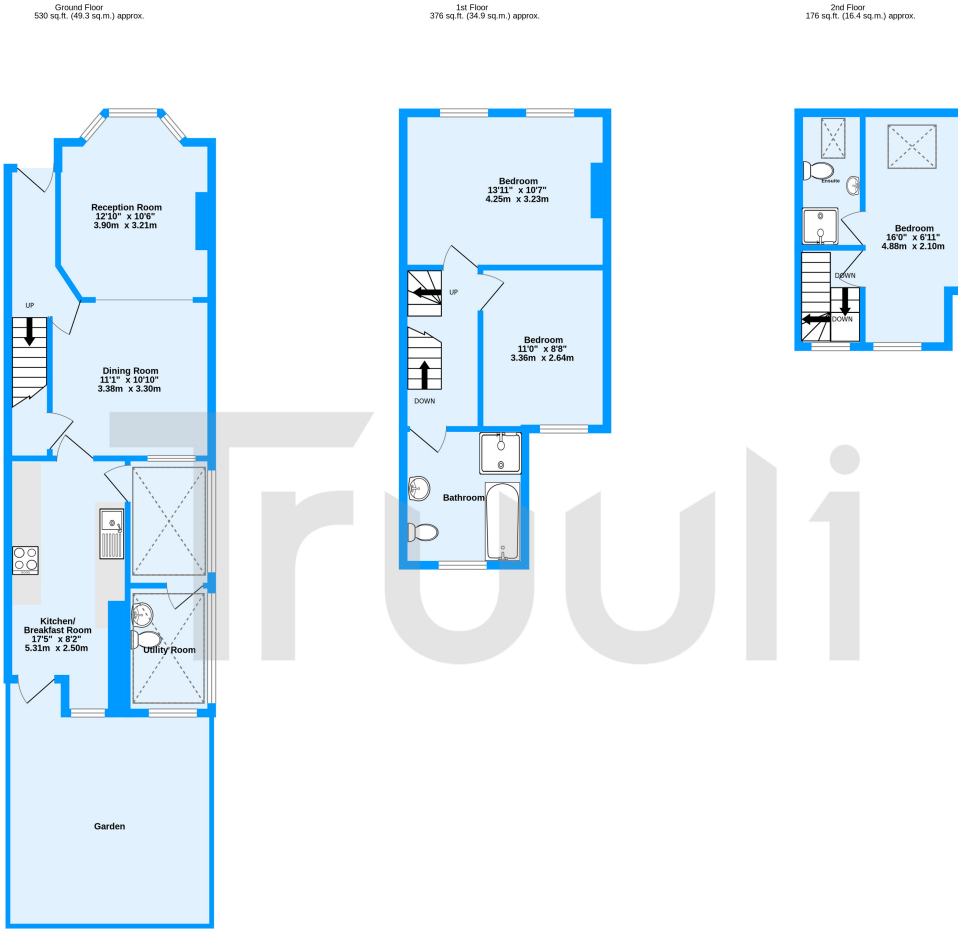

Burlington Road, Thornton Heath, CR7  
TOTAL FLOOR AREA : 1083 sq.ft. (100.6 sq.m.) approx.  
Measurements are approximate. Not to scale. Illustrative purposes only  
Made with MetroPix ©2023

Energy Efficiency Rating		Current	Potential
Very energy efficient - lower running costs			
(92-100) <b>A</b>			
(81-91) <b>B</b>			
(69-80) <b>C</b>			78
(55-68) <b>D</b>		51	
(39-54) <b>E</b>			
(21-38) <b>F</b>			
(1-20) <b>G</b>			
Not energy efficient - higher running costs			
England, Scotland & Wales		EU Directive 2002/91/EC	

