

Truuli



Station Road, Croydon, Surrey, CR0

£367,000 Leasehold

- Delightful views
- Under floor heating in every room
- 10 year NHBC warranty
- Winter garden accessed from the living area
- 24-hour concierge and security service
- Access to three communal terraces and a resident's lounge
- Prime location

2, Lansdowne Road, Croydon, Surrey, CR9 2ER

Tel: 0330 043 0002

Email: save@truuli.co.uk Web: www.truuli.co.uk

Station Road, Croydon, Surrey, CR0

£367,000 Leasehold

The newest and most exciting development to come to Croydon, London Square is now available for you to reserve. With 108 apartments available the developers have really gone for an impressive contemporary style throughout.

Sydenham Road

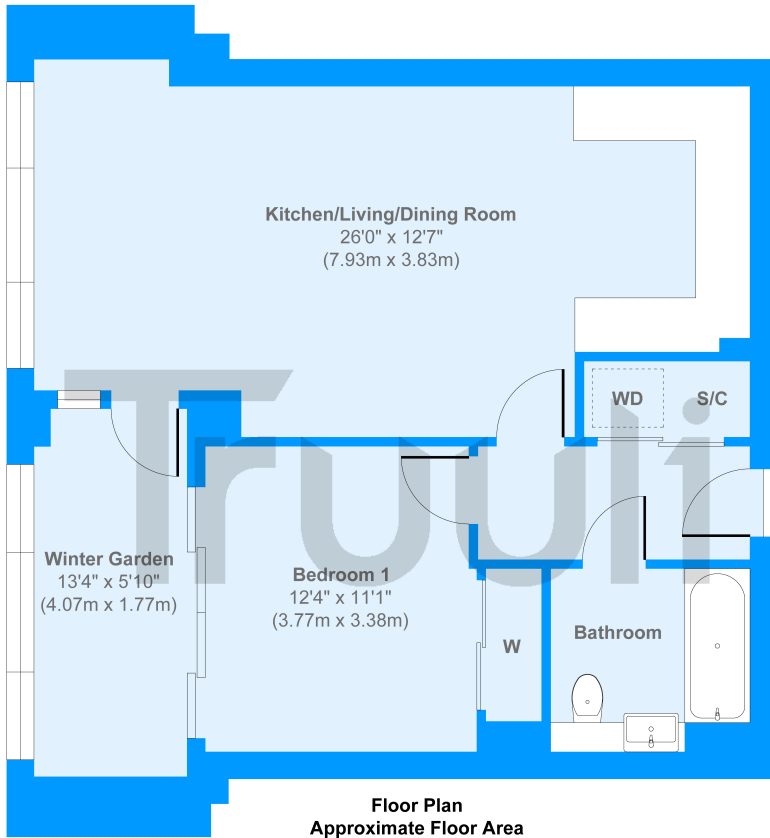

Floor Plan
Approximate Floor Area
551 sq. ft
(51.23 sq. m)

Approx. Gross Internal Floor Area 551 sq. ft / 51.23 sq. m

Produced by Elements Property

