

Truuli



Stanford Road, London, SW16

£460,000 Freehold

- Allocated parking space
- Two en suite shower rooms
- Downstairs WC
- Close to local Recreation grounds
- Ready to move in
- Close to Norbury and Streatham common stations

2, Lansdowne Road, Croydon, Surrey, CR9 2ER

Tel: 0330 043 0002

Email: save@truuli.co.uk Web: www.truuli.co.uk

Stanford Road, London, SW16

£460,000 Freehold

A well maintained two bedroom, two bathroom freehold house on Stanford Road, Norbury. The property offers a well maintained garden and also has its own parking space.

Stanford Road is a popular road that is close to two mainline stations with excellent transport links into London.

Ground Floor
347 sq.ft. (32.2 sq.m.) approx.

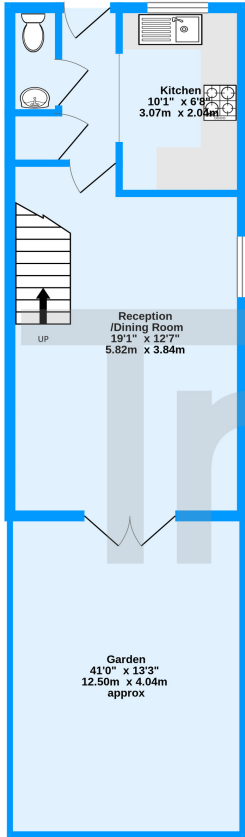

1st Floor
347 sq.ft. (32.2 sq.m.) approx.

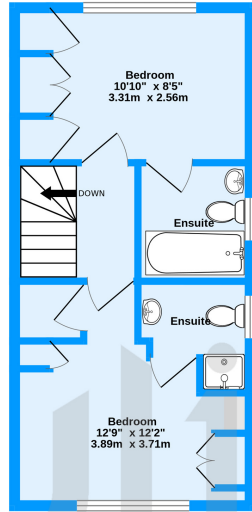

Stanford Road, Norbury, SW16
TOTAL FLOOR AREA: 694 sq.ft. (64.4 sq.m.) approx.
Measurements are approximate. Not to scale. Illustrative purposes only
Made with Metropix ©2023

Energy Efficiency Rating		
	Current	Potential
Very energy efficient - lower running costs		
(92-100) A		
(81-91) B		87
(69-80) C	69	
(55-68) D		
(39-54) E		
(21-38) F		
(1-20) G		
Not energy efficient - higher running costs		
England, Scotland & Wales	EU Directive 2002/91/EC	

