

Truuli



Thirsk Road, Mitcham, Surrey, CR4

£600,000 Freehold

- Off street parking
- Four bedroom family home
- Two reception rooms
- Master bedroom on top floor with en suite
- Separate kitchen
- Close to green open spaces
- Scope to extend further (subject to planning)

2, Lansdowne Road, Croydon, Croydon, CR9 2ER

Tel: 0330 043 0002

Email: save@truuli.co.uk Web: www.truuli.co.uk

Thirsk Road, Mitcham, Surrey, CR4

£600,000 Freehold

*** Agents comments *** " The property is situated close to Tooting and within walking distance of the large open green space of Figgs Marsh & Tooting Bec Common, you also benefit from having Ofsted-rated Schools, and local amenities on your doorstep...."

Ground Floor
471 sq.ft. (43.7 sq.m.) approx.

1st Floor
434 sq.ft. (40.4 sq.m.) approx.

2nd Floor
346 sq.ft. (32.1 sq.m.) approx.

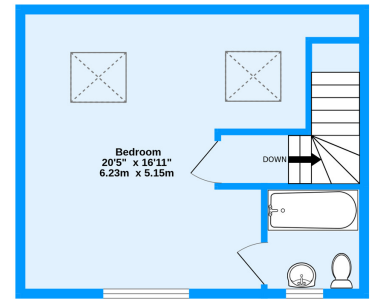
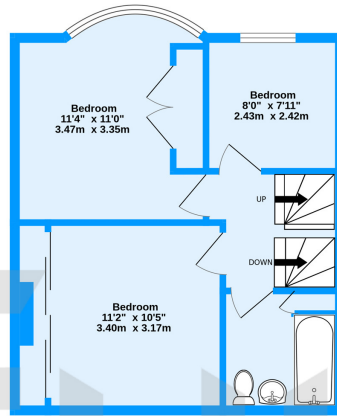
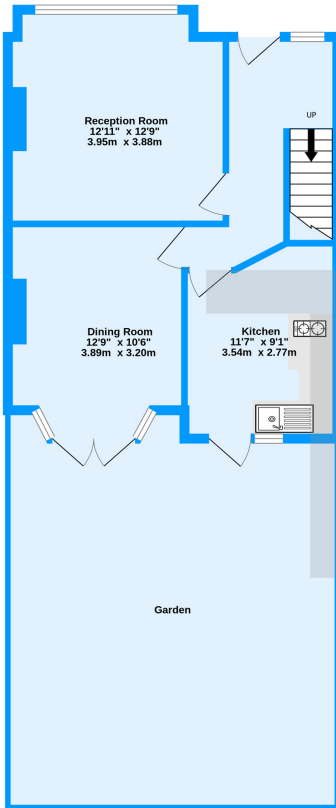

Thirsk Road, Mitcham, CR4

TOTAL FLOOR AREA : 1251 sq.ft. (116.2 sq.m.) approx.

Measurements are approximate. Not to scale. Illustrative purposes only
Made with Metropix ©2023

Energy Efficiency Rating		Current	Potential
Very energy efficient - lower running costs			
(92-100)	A		
(81-91)	B		87
(69-80)	C	71	
(55-68)	D		
(39-54)	E		
(21-38)	F		
(1-20)	G		
Not energy efficient - higher running costs			
England, Scotland & Wales		EU Directive 2002/91/EC	

