

# Truuli



## Edridge Road, Croydon, Surrey, CR0

£350,000 Leasehold

- Two double bedrooms
- Open plan living
- Chain free
- Central location for all amenities
- Access to communal roof terrace and a "Resident's Lounge"
- Utility cupboard

# Edridge Road, Croydon, Surrey, CR0

£350,000 Leasehold

\*\*Vendor's comments:\*\* "This flat has been the perfect first home for us as a couple and we are selling as we are planning to move to spend some time with family before we move back to Australia."

As young professionals, it's been idyllic for living and working from home as well as a short commute into London for work, seeing friends, or travelling abroad."

4th Floor  
674 sq.ft. (62.6 sq.m.) approx.

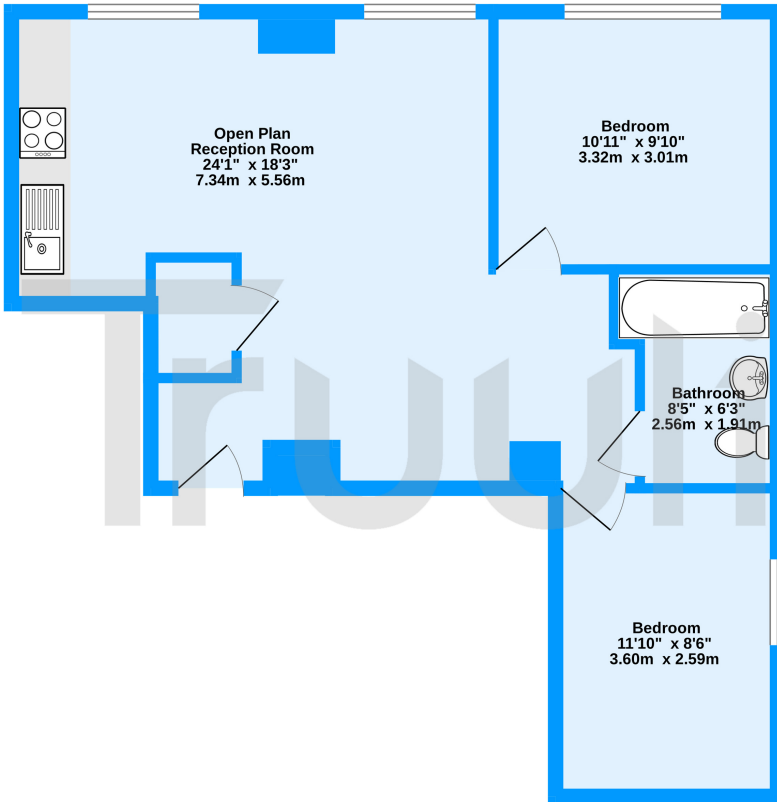

The Residences, Edridge Road, Croydon, CR0  
TOTAL FLOOR AREA: 674sq.ft. (62.6 sq.m.) approx.  
Measurements are approximate. Not to scale. Illustrative purposes only  
Made with Metropix ©2023

