

# Truuli



## Windermere Road, London, SW16

£475,000 Freehold

- Off street parking
- Your chance to put your own stamp on a property
- No onward chain
- Four bedroom family home
- Close to Rowan Road Recreation ground
- A mile to Streatham Common station
- Guide price £475,000 - £500,000

Southbridge Place, Surrey, CR0 4HA

Tel: 0330 043 0002

Email: [save@truuli.co.uk](mailto:save@truuli.co.uk) Web: [www.truuli.co.uk](http://www.truuli.co.uk)

# Windermere Road, London, SW16

£475,000 Freehold

\*\*\* Guide Price £475,000 - £500,000 \*\*\* A fantastic chance to acquire this 1930s mid-terrace family home offering an open plan double reception room, galley kitchen and four bedrooms, located on Windermere Road, Streatham.

Ground Floor  
422 sq.ft. (39.2 sq.m.) approx.

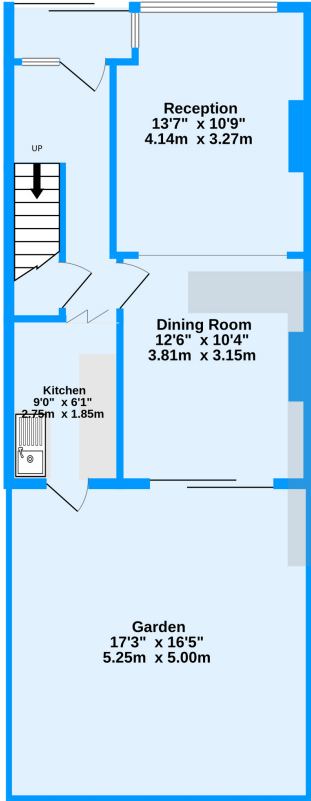

1st Floor  
409 sq.ft. (38.0 sq.m.) approx.

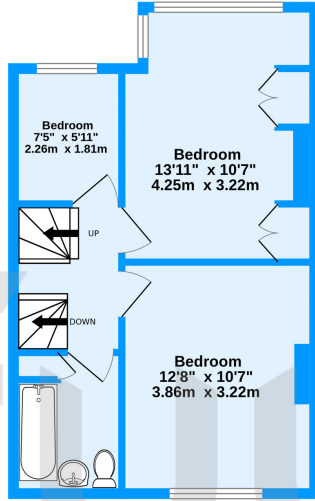

2nd Floor  
272 sq.ft. (25.3 sq.m.) approx.

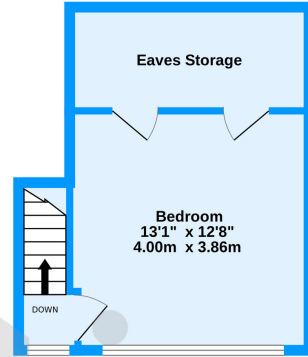

Windermere Road, London, SW16

TOTAL FLOOR AREA : 1103 sq.ft. (102.4 sq.m.) approx.  
Measurements are approximate. Not to scale. Illustrative purposes only  
Made with Metropix ©2023

