

Truuli



Gillett Road, Thornton Heath, Surrey, CR7 8SN

£360,000 Freehold

- Split level accommodation
- High street close by with an array of amenities
- No onward chain
- Private rear garden
- Freehold property
- Plenty of internal storage

Gillett Road, Thornton Heath, Surrey, CR7 8SN

£360,000 Freehold

This fantastic three-bedroom property offers well-proportioned interiors throughout, boasting three good-sized bedrooms and a spacious kitchen.

Ground Floor
547 sq.ft. (50.9 sq.m.) approx.

1st Floor
334 sq.ft. (31.0 sq.m.) approx.

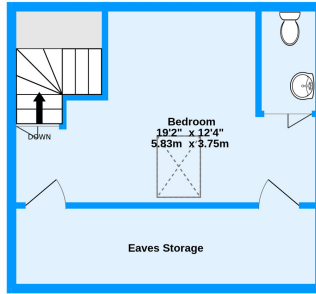
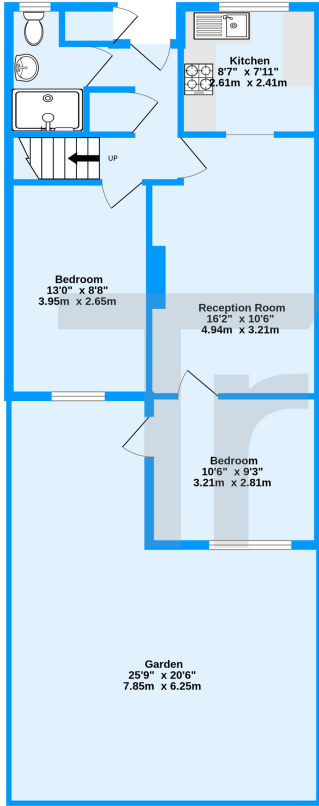

Gillett Road, Thornton Heath, CR7
TOTAL FLOOR AREA: 881 sq.ft. (81.9 sq.m.) approx.
Measurements are approximate. Not to scale. Illustrative purposes only
Made with Metropix ©2024

Energy Efficiency Rating		Current	Potential
Very energy efficient - lower running costs			
(92+)	A		90
(81-91)	B		
(69-80)	C		
(55-68)	D	66	
(39-54)	E		
(21-38)	F		
(1-20)	G		
Not energy efficient - higher running costs			
England, Scotland & Wales		EU Directive 2002/91/EC	

