

# Truuli



**Mayfield Road, Thornton Heath, Surrey, CR7 6DN**

£500,000 Freehold

- Close to Mayfield Park
- Well maintained family home
- Extended kitchen breakfast room
- Lovely low maintenance garden
- Double doors leading to the garden
- Downstairs WC and Upstairs bathroom

Southbridge Place, Surrey, CR0 4HA

Tel: 0330 043 0002

Email: [save@truuli.co.uk](mailto:save@truuli.co.uk) Web: [www.truuli.co.uk](http://www.truuli.co.uk)

# Mayfield Road, Thornton Heath, Surrey, CR7 6DN

£500,000 Freehold

A most impressive three-bedroom house that is neutrally decorated with an open plan kitchen/dining area located on Mayfield Road, Thornton Heath, makes this a lovely family home.

Ground Floor  
668 sq.ft. (62.1 sq.m.) approx.

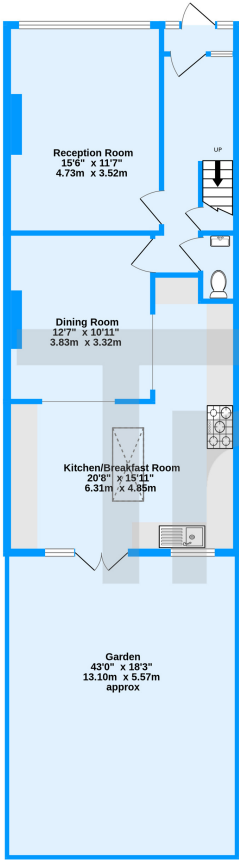

1st Floor  
447 sq.ft. (41.5 sq.m.) approx.

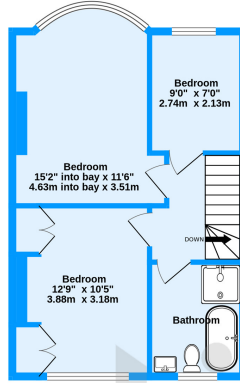

Mayfield Road, Thornton Heath, CR7

TOTAL FLOOR AREA: 1116 sq.ft. (103.6 sq.m.) approx.  
Measurements are approximate. Not to scale. Illustrative purposes only  
Made with MetroPix ©2024

