

Truuli



Croham Park Avenue, South Croydon, Surrey, CR2 7HH

£475,000 Share of Freehold

- Redecorated throughout
- Beautiful period flat
- High ceilings
- Architectural features
- Luxury bathroom complete with a separate rain shower
- Own private mature garden
- Well maintained and quiet building
- Built in storage throughout
- Plantation shutters throughout
- Abundance of light

Southbridge Place, Surrey, CR0 4HA

Tel: 0330 043 0002

Email: save@truuli.co.uk Web: www.truuli.co.uk

Croham Park Avenue, South Croydon, Surrey, CR2 7HH

£475,000 Share of Freehold

Set on a peaceful, residential road in South Croydon, this beautiful period flat on Croham Park Avenue is immediately available to view.

First Floor
915 sq.ft. (85.0 sq.m.) approx.

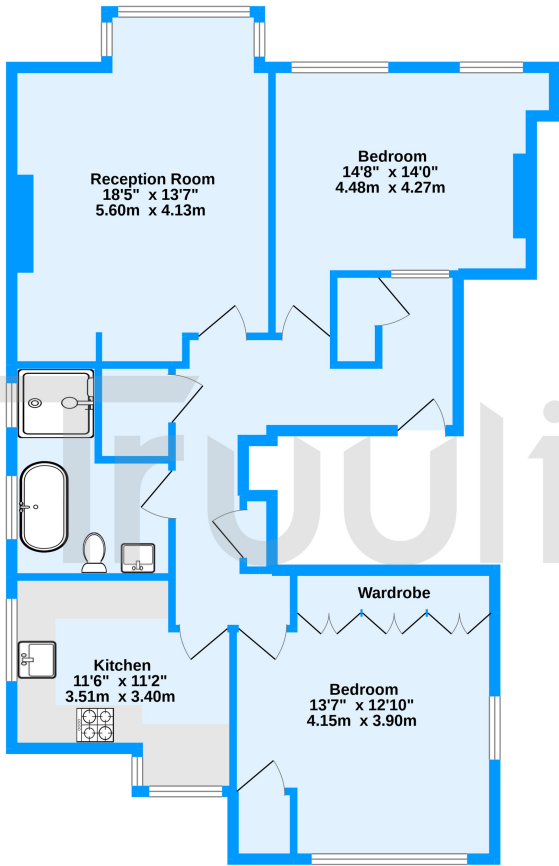

Croham Park Avenue, Croydon, CR2

TOTAL FLOOR AREA: 949sq.ft. (88.2 sq.m.) approx.

Whilst every attempt has been made to ensure the accuracy of the floorplan contained here, measurements of doors, windows, rooms and any other items are approximate and no responsibility is taken for any error, omission or mis-statement. This plan is for illustrative purposes only and should be used as such by any prospective purchaser. The services, systems and appliances shown have not been tested and no guarantee as to their operability or efficiency can be given.
Made with Metropix ©2022

Energy Efficiency Rating

	Current	Potential
Very energy efficient - lower running costs		
(92-100) A		
(81-91) B		81
(69-80) C	69	
(55-68) D		
(39-54) E		
(21-38) F		
(1-20) G		
Not energy efficient - higher running costs		
England, Scotland & Wales	EU Directive 2002/91/EC	

