

Truuli



Parchmore Road, Thornton Heath, Surrey, CR7 8HD

£450,000 Freehold

- Close to transport links
- End of terrace
- HMO licence
- Off street parking space
- Two internal studios
- Private garden
- Available immediately

Parchmore Road, Thornton Heath, Surrey, CR7 8HD

£450,000 Freehold

Located just a short walk from Thornton Heath Station, this end-of-terrace HMO with a licence is near the vibrant High Street and local amenities.

It is a rare and exciting investment opportunity as the property is well-designed, comprising three spacious bedrooms and two one-bedroom studio flats, each with their own kitchen and bathroom providing a versatile setup for potential tenants.

Ground Floor
379 sq.ft. (35.2 sq.m.) approx.

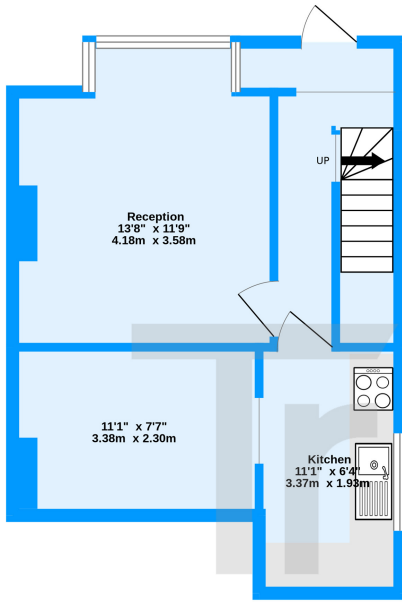

1st Floor
505 sq.ft. (46.9 sq.m.) approx.

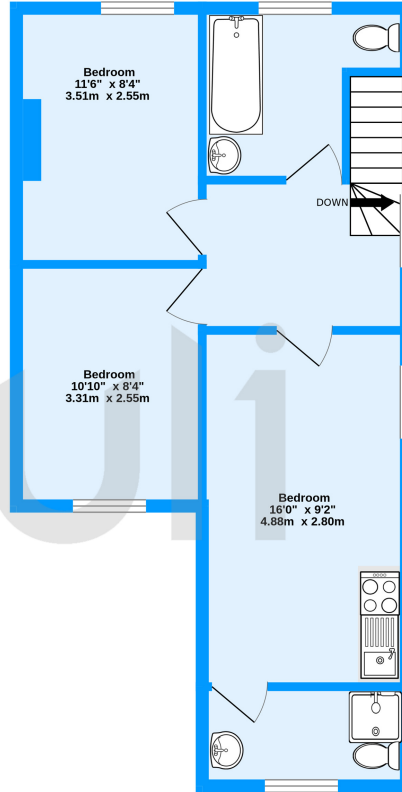

Parchmore Road, Thornton Heath, CR7

TOTAL FLOOR AREA: 884 sq.ft. (82.1 sq.m.) approx.
Measurements are approximate. Not to scale. Illustrative purposes only
Made with Metropix ©2024

Energy Efficiency Rating		Current	Potential
Very energy efficient - lower running costs			
(92+)	A		
(81-91)	B		
(69-80)	C		
(55-68)	D	58	
(39-54)	E		
(21-38)	F		
(1-20)	G		
Not energy efficient - higher running costs			
England, Scotland & Wales		EU Directive 2002/91/EC	

