

Truuli



88 Illingworth Close, Mitcham, Surrey, CR4 3QH

£230,000 Leasehold

- No Onward Chain
- Quiet Residential Close
- 2nd Floor Flat
- Spacious Reception Room
- Double Bedroom
- Kitchen
- Viewings Are a Must
- Balcony off of the living room

88 Illingworth Close, Mitcham, Surrey, CR4 3QH

£230,000 Leasehold

In need of updating and modernisation, the flat presents a blank canvas for those ready to transform it into a stylish and comfortable living space. Perfect for first-time buyers, DIY enthusiasts, or investors seeking potential, this property is full of possibilities.

Second Floor
534 sq.ft. (49.6 sq.m.) approx.

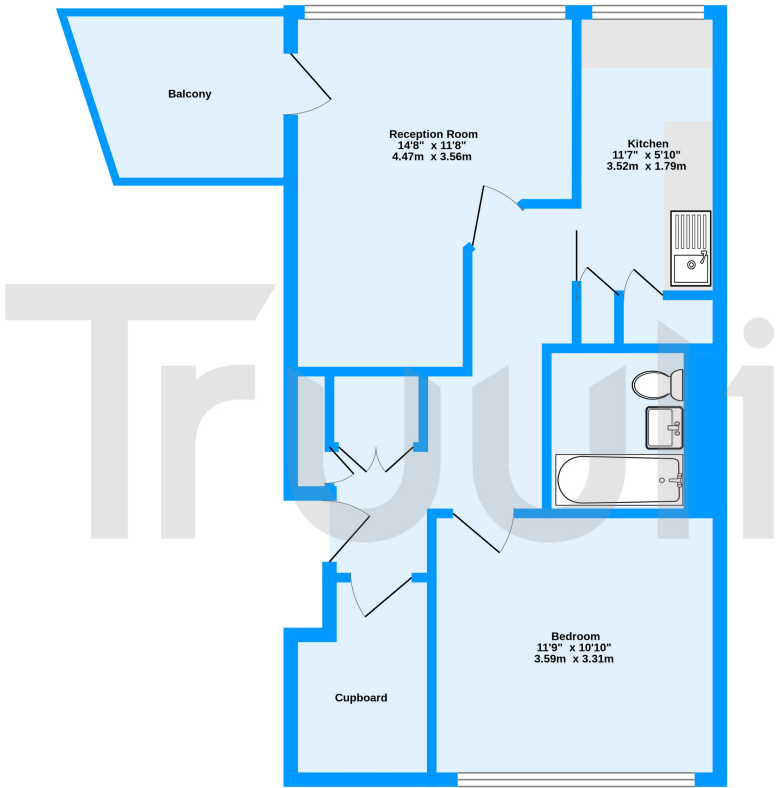

Illingsworth Close, Mitcham, CR4
TOTAL FLOOR AREA : 534 sq.ft. (49.6 sq.m.) approx.
Measurements are approximate. Not to scale. Illustrative purposes only
Made with Metropix ©2024

Energy Efficiency Rating		
	Current	Potential
Very energy efficient - lower running costs		
(92+) A		
(81-91) B		
(69-80) C		
(55-68) D	69	76
(39-54) E		
(21-38) F		
(1-20) G		
Not energy efficient - higher running costs		
England, Scotland & Wales		
EU Directive 2002/91/EC		

